



Part # 31900050 - 31009000



1

Difficulty- Easy

1

Tools- none

RideTech Mobile Phone Remote /  
e3 Bluetooth module.

## Installation Instructions

### Table of contents

Page 2.....	Included components
Page 3.....	Installing Bluetooth kit (310090000)
page 4.....	Installing Bluetooth upgrade (31900050)
Page 5.....	Learning key fobs
Page 6.....	Pairing a Android device
Page 7.....	Pairing a iOS device (Apple)
Page 8.....	Using your mobile app





## Included Components .....In the box

### Complete Kit #31009000



Description	Part#	QTY
RidePRO e3 bluetooth Smart Phone Module	31900050	1
E3 Remote kit	31900043	1
Key fobs	31900042	2
Antenna	31900041	1
USB Cable	31900049	1

### Upgrade Kit #31900050



Description	Part#	QTY
RidePRO e3 bluetooth Smart Phone Module	31900050	1



### Installing E3 bluetooth kit Part # 31009000

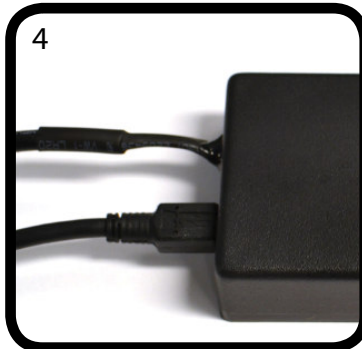

1- First unplug the control panel.

2. Next using the cable you just unplugged install into new Bluetooth remote node module.

3. Using the supplied usb cable install the larger end into the Bluetooth module and small end into e3 display.

4. Next install antenna wire into Bluetooth module.

5. Now you're ready to program your key fobs.

- To learn remotes See Page 5

6. To Pair your smart phone see Pairing Devices page 6-7.

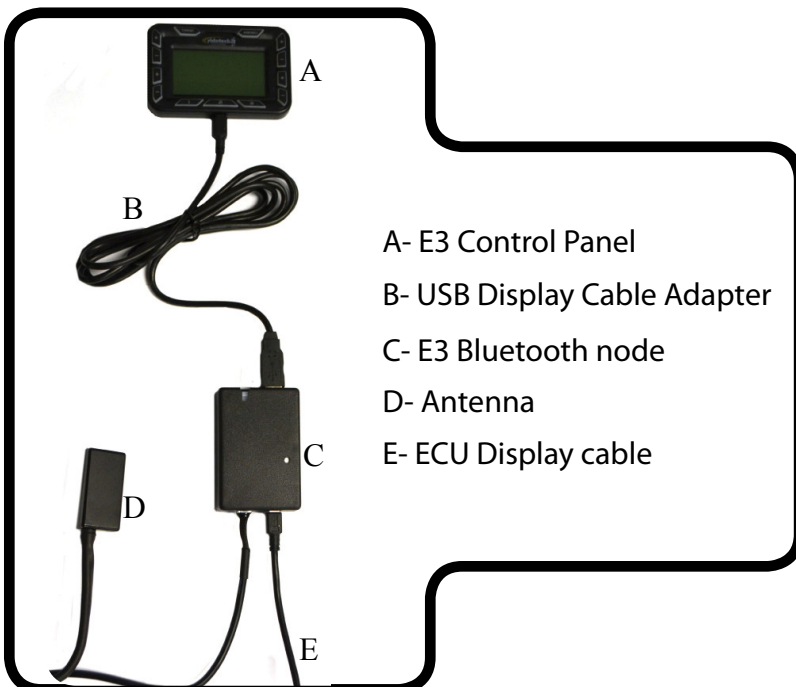



### Installing e3 Bluetooth upgrade Part # 31900050

1

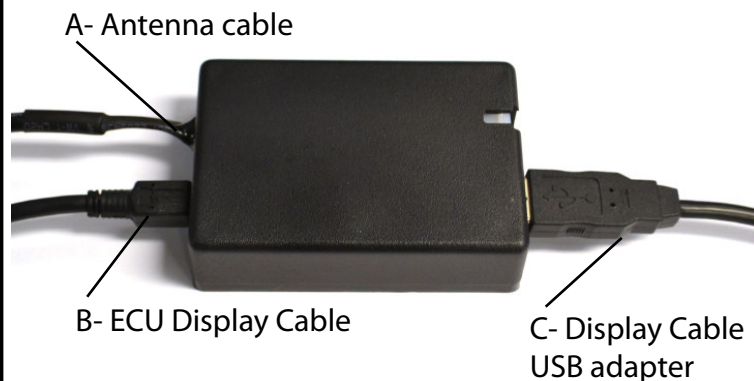

1- first unplug cables from your existing standard remote node.

- A- Antenna cable
- B- ECU Display Cable
- C- Display Cable USB Adapter

2- Next plug the same cables into new Bluetooth node.

2



Now you're ready to pair your new e3 Bluetooth with your smart phone.

\*See Pairing your device page 6-7

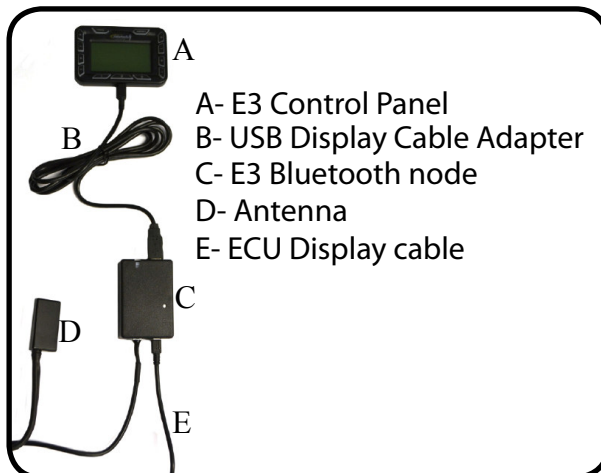





## Learning e3 Remote Key Fobs

1. Ignition power  
ON



### LEARNING KEY FOBBS

Now that we have the remote node, antenna, and control panel installed. The next step is to learn your keyfobs to your system.

2



3



1- Turn ignition power on

2- Press the menu button on the e3 display panel. Next scroll down to the wireless remote option, press select (#2)

4

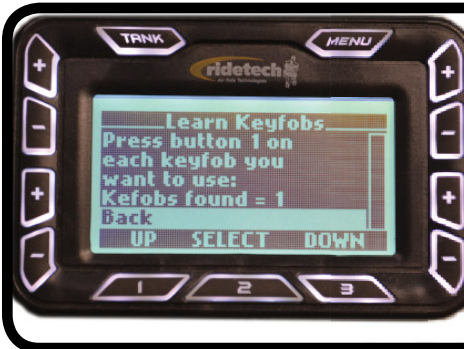

3- Next, select "Learn Keyfobs"

4- Now press #1 on primary remote, then press #1 on the secondary remote. after pressing #1 the panel will show each keyfob found.

5



6



5. When the remotes are learned and keyfob's are found. Select the #2 button to finish.

6. After pressing #2 The screen will show you that the remotes have be learned. Now your remotes are ready to go.



### Pairing Devices (Android)

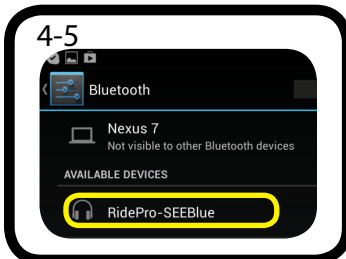
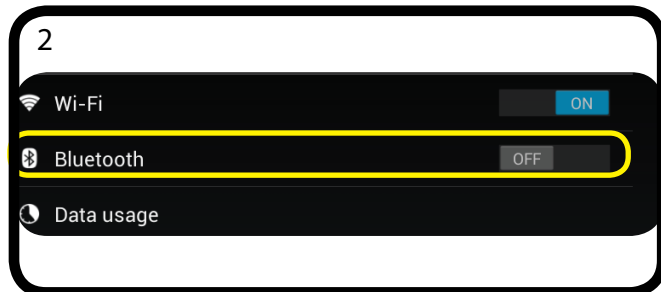
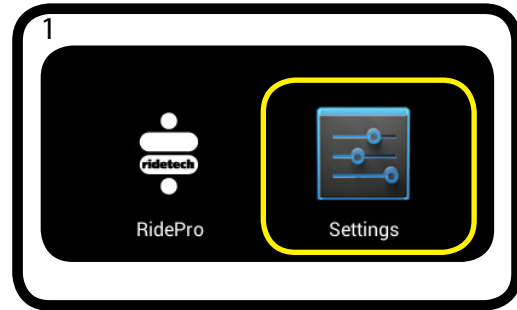

1- On Android device go to "Settings"

2- Turn Bluetooth ON

3- The LED indicator on the RidePro e3 Bluetooth Module will be solid yellow.

4- Press the Bluetooth button to search for devices.

5- Select "RidePro-SEEBLue" device

6- "Bluetooth pairing request" box will show up.  
- Next it will list a passkey, which is the unique key between the mobile device and the Bluetooth node

\*\* NOTE- you will not be able to see the passkey on the e3 panel.

-Select "Pair" a "paired" icon will be displayed on the Android device. The LED indicator on the RidePro e3 Bluetooth Module will be solid red to indicate the devices are paired

7- Run the RidePro mobile Application.

- LED will be solid green

-if ignition is ON you have full control

-if ignition is OFF you can control only the three presets

-if you don't have the App installed on your device see page 8\*

\*\*\*NOTES: If you turn off Bluetooth, or if the device moves too far away for proper connection, the LED will stay solid Red, indicating that the RidePro e3 Bluetooth Module is paired to a device but it is not connected. When APP is turned on the LED will turn solid green, indicating the RidePro e3 Bluetooth Module is paired and connected.

To Re-Pair or Pair a new mobile device:

1- Turn vehicle ignition ON

2- Wait 10 seconds

3- Turn vehicle ignition OFF

4- Press and hold the "reset" button on the side of the RidePro e3 Bluetooth Module for 5 seconds  
- when the device is ready it will show a solid yellow LED

5-Follow the steps above to pair a new mobile device

[www.ridetech.com](http://www.ridetech.com)

812-482-2932



### Pairing Devices iOS (APPLE)

Pairing iOS device:

1- When using iOS device go to "Settings"

2- Next turn Bluetooth ON  
-iOS device will automatically locate any Bluetooth devices and list them

3- The LED indicator on the RidePro e3 Bluetooth Module will be solid Yellow

4- Select "RidePro-SEEBLue" device

5- "Bluetooth pairing request" box will show up  
-it will list a passkey, which is the unique key between the mobile device and the I/O Node

\*\* NOTE -you will not be able to see the passkey on the e3  
Select "Pair"

-the LED indicator on the RidePro e3 Bluetooth Module will be solid Blue, to indicate the devices are being paired, then solid green to indicate the devices are paired

6- Run the RidePro mobile App

-if ignition is ON you have full control

-if ignition is OFF you can control only the three presets

\* if you don't have the App installed on your device  
see page 8\*

\*\*\*NOTES: If you turn off Bluetooth, or if the device moves too far away for proper connection, the LED will turn solid Red for five seconds, indicating that the RidePro e3 Bluetooth Module is paired to a device but it is not connected. The LED will then flash Yellow five times, indicating the RidePro e3 Bluetooth Module is trying to locate the device to which it is paired.

When Bluetooth is turned on, or if the device is within range, the LED will turn solid Blue, indicating the RidePro e3 Bluetooth Module is connecting to the device, then solid Green, indicating the device is paired and connected.

To Re-Pair or Pair a new mobile device:

1- Turn vehicle ignition ON

2- Wait 10 seconds

3- Turn vehicle ignition OFF

4- Press and hold the "reset" button on the side of the RidePro e3 Bluetooth Module for 5 seconds  
- When the device is ready it will show a solid yellow LED

5- Follow the steps above to pair a new mobile device

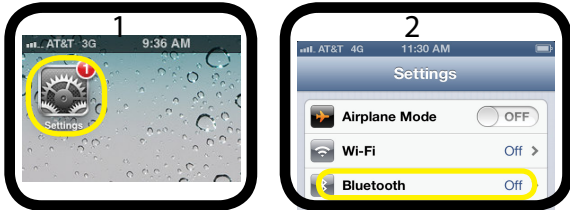





### Mobile App

#### 1 iPhone Application

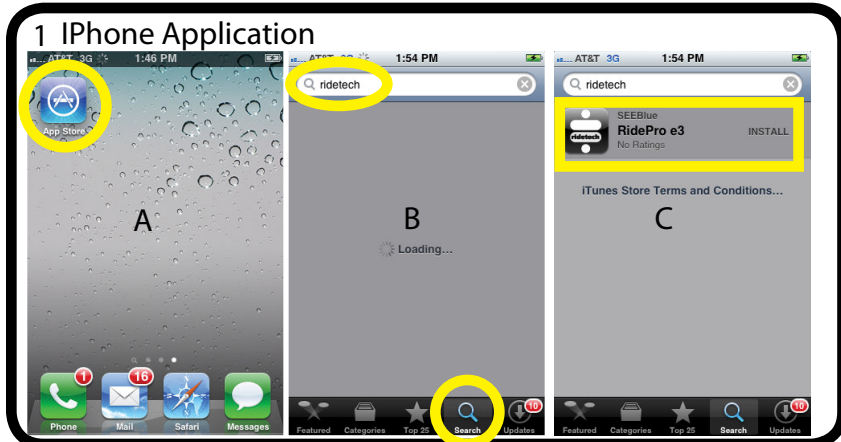

- 1- Install app on mobile device.  
-iPhone users go to app Store to download app.
  - A. Go to app Store
  - B. Press search and type in ridetech.
  - C. Press install

- 2 - Android users go to Google play to download App.

- A. go to Google Play
- B. Push the search button
- C. Type in ridetech
- D. Select the RidePro App

#### 2 Android Application

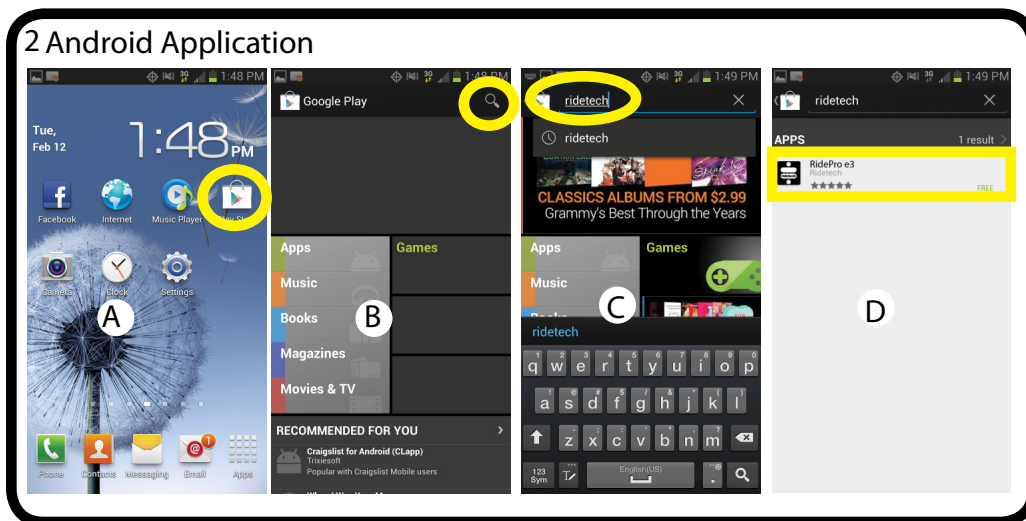

- 3-4. After installing open app on mobile device.

5. This is the verticle layout. the large 1,2,3 buttons are used for vehicle presets. simply press to activate. the additional + & - buttons act as full manual control.

6. When turning your mobile device to it's landscape mode, it will show the complete control panel. This works just like the e3 panel inside your vehicle. For additional functions and features see e3 instruction manual.

#### 3 Android

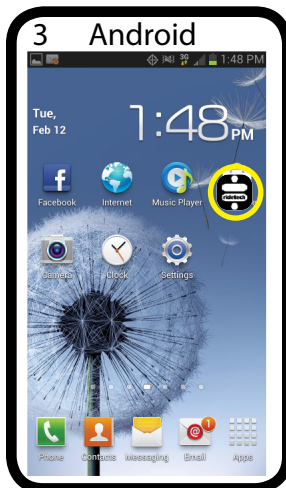

#### 4 iPhone

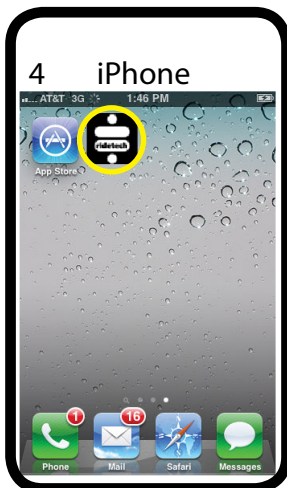

#### 5



#### 6

